



A Safe Fleet Brand

Form 948

1/20

Electronic Concentrate Management System

Single or Dual Tank with Off-Board Pick-Up with Automatic Flush

- 1" Single Tank with OBPU (12 VDC) - P/N 3435-0184**
- 1" Single Tank with OBPU (24 VDC) - P/N 3435-1005**
- 1 1/2" Single Tank with OBPU (12 VDC) - P/N 3435-1006**
- 1 1/2" Single Tank with OBPU (24 VDC) - P/N 3435-1007**
- 1" Dual Tank with OBPU (12 VDC) - P/N - 3435-1003**
- 1" Dual Tank with OBPU (24 VDC) - P/N 3435-1008**
- 1 1/2" Dual Tank with OBPU (12 VDC) - P/N 3435-1009**
- 1 1/2" Dual Tank with OBPU (24 VDC) - P/N 3435-1010**

INSTALLATION AND OPERATION MANUAL

Unit Serial Number _____

All quality FoamPro products are ruggedly designed, accurately machined, carefully assembled, thoroughly inspected and tested. In order to maintain the high quality of your unit, and to keep it in a ready condition, it is important to follow the instructions on care and operation. Proper use and good preventive maintenance will lengthen the life of your unit. ALWAYS INCLUDE THE UNIT SERIAL NUMBER IN CORRESPONDENCE.

TABLE OF CONTENTS

SECTION	PAGE
1 SAFETY	3
2 A QUICK LOOK AT HOW THE SYSTEM WORKS	4
3 WHAT YOU GET	4
4 WHAT YOU SUPPLY	5
5 PLAN AHEAD	6
6 PLUMBING THE SYSTEM	6
7 ELECTRONIC COMPONENT INSTALLATION	9
8 OPERATION INSTRUCTIONS	13
9 TROUBLESHOOTING	15
10 PARTS IDENTIFICATION	16
11 PARTS OUTLINE DRAWINGS	17
12 WARRANTY	Back Cover

NOTE TO SYSTEM INSTALLERS

IMPORTANT: Please provide a copy of the FoamPro manual to the end user of the equipment.
For additional FoamPro manuals, contact by FAX 816-892-3178, web site www.foampro.com,
or call 800-533-9511. Request Form No. 948.

1 Safety

Please read all of the following safety precautions and follow them carefully. They are important to the prevention of personal injury or damage to the equipment.

1. **Always disconnect the power source** before servicing any part of the dual foam source system.
2. **Release all pressure** within the system before servicing any of its component parts.
3. **Drain all liquids** from the system before servicing any of its component parts.
4. **Check all hoses** for weak or worn conditions monthly. Make sure that all connections and fittings are tight and secure.
5. **Use inlet pipe**, hose, and fittings - from the foam sources to the selector valve - that are rated for 23 inches Hg vacuum (584 mm Hg) and 50 psi (3 BAR) pressure and are compatible with foam agents.
6. **Use inlet pipe**, hose and fittings:
 - from the selector valve to the inlet of the foam pump.
 - and from the flush line connector to the flush solenoid on the selector valve.Use inlet pipe, hose and fittings that are rated at or above the maximum pressure (400 psi minimum) rating at which the water pump system may operate.
7. **Any electrical system** has the potential to cause sparks during service. Eliminate explosive or hazardous environments during service/repair.
8. **The components and fittings** used in this system must be compatible with the foam concentrates used and pressures at which the pump system operates.
9. **CAUTION:** Do not operate the system at or above a temperature of 160° F (71°C).
10. **CAUTION:** Make sure the electrical source of power for the unit is the appropriate, constant 12-volt or 24-volt, negative ground DC system. Power and ground lines must come directly from the battery without any connections to other high power devices, such as primer pumps, hose reels, light bars, etc. See Section 7 for more specific instructions.
11. **CAUTION:** Periodically inspect all foam pump and all system components. Perform routine preventive maintenance as required.
12. **CAUTION:** Do not manually turn selector valves with power to the system. Damage to the valve actuator will occur.

2 A Quick Look at How the System Works

The Electronic Concentrate Management System allows for the connection of one or two apparatus-mounted foam sources and an Off-Board Pick-Up into your FoamPro Foam Proportioning System. The system provides an interface with the main system controller and a flush position.

The interface with the system controller supplies dual calibration and dual injection rates. The dual calibration allows accurate calibration of two (2) foam concentration sources separately and automatic switching of that calibration when changing sources. The Dual-Tank injection rate allows the presetting of the defaulted injection rate for two (2) foam concentrate sources. This feature will also automatically switch when changing sources by using the toggle switch controller.

The electronics provide an automatic 8-second flush when switching from one source to another. When the selector is left in the flush position (center position), water discharge pressure is open to the

suction of the foam pump for approximately one minute. Since the discharge of the foam pump is piped to the water discharge, flushing action will take place when the foam pump is run until it is switched to one of the foam sources.

The system comes with control switch panel(s) that indicate which is being used, and a 20 foot interface cable. The cable allows the usage of the dual calibration and defaulted injection rate features in the system controller. A flush indicator lamp is wired into the system to provide positive indication that the flush or off position has been selected.

A tank level sensor must be provided for each foam concentration tank mounted in the apparatus. The internal switches will signal the system controller when the tank being used is low or out of foam concentrate. The source not being used is not monitored for low concentrate. The off-board foam source is also not automatically monitored and must be monitored manually.

3 What You Get

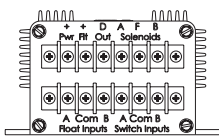

Electronic Control Module

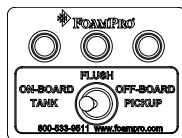

Single Onboard Tank
with Off-Board Control

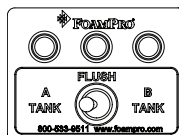

Dual Onboard Tank
with Off-Board Controls

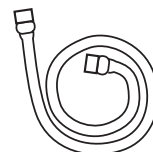
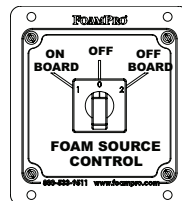

Digital Display
Interface Cable

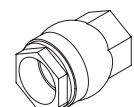

Foam Tank Check
Valve(s)

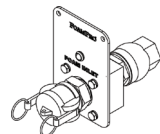

Off-board
Pickup Panel

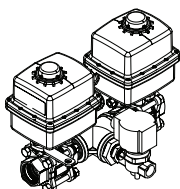

Selector Valve - Electronic
Single Onboard Tank
and Off-Board Selector
Valve Assembly

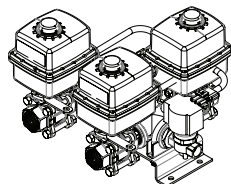

Dual Onboard tank
and Off-Board Selector
valve Assembly

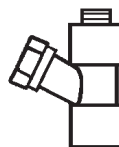

Foam Tank Strainer(s)
(one supplied with
proportioner system)

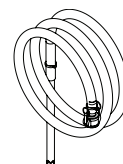

Suction Hose
Kit

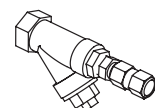

Flush Line Strainer
and Check Valve

Optional System Accessories Available

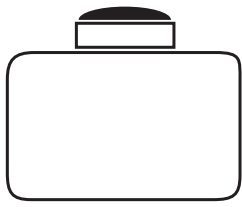

Foam Tank(s)
 8 gallon, polypropylene (P/N 1530-0005)
 12 gallon, polypropylene (P/N 1530-0012)
 20 gallon, polypropylene (P/N 1530-0022)
 Requires additional hardware for compliance with the NFPA

Tank Level Sensors
 (One for each foam cell is required)

Side-Mount
 1/2" NPT thread
 (P/N 2510-0032)

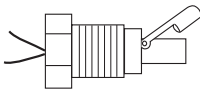

or

Vertical-Mount
 1/8" NPT thread
 (P/N 2510-0028)

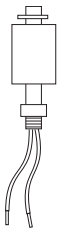

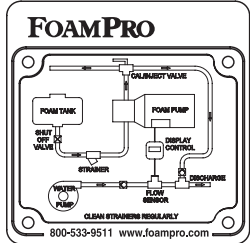

Placard
 (P/N 6032-0016)

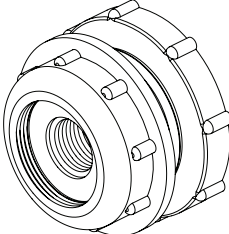

Bulkhead Tank Fitting
 For use with Side-Mount Low Level Sensor
 (P/N 2400-0113)

4 What You Supply

ITEMS NEEDED:

1. Shut-off valves, quarter turn, NPT to match the CMS valves (two), (brass or stainless steel)
2. Pipe tee, to suit water pipe and flush line size
3. Low pressure, clear suction hoses (1" minimum inside diameter for 1" CMS, 1-1/2" minimum for 1-1/2" CMS)
4. Foam sources (two) sized to customer's specifications.
5. High pressure hose

FOAM SOURCE TO INTAKE OF FOAM PUMP

Fittings and hoses from the foam source to the inlet of the selector valves will need to be supplied by the installer. Use 1" inside diameter hose for the 1" CMS and 1-1/2" minimum ID for the 1-1/2" CMS. Use components that are rated for 23 inches (584

mm) Hg and 50 psi (3 BAR) working pressure. Hose from the selector valve to the foam pump should be at least 400 psi (28 BAR) or greater capacity to withstand the water pressure of the water pump during flushing. All hoses and fittings must be compatible with the foam concentrates that will be used.

NOTES:

NFPA requirement: A foam injection check valve is required in the foam pump discharge to prevent backflow of water into the foam concentrate injection system.

SYSTEM WIRING

Standard automotive 16 AWG wire or larger may be used. It is recommended that wiring be bundled with wire ties and protected with loom.

See Section 7 for more specific wiring instructions.

5 Plan Ahead

Because of the potential differences in fire apparatus plumbing and foam system configuration, it is not practical to depict exactly how each FoamPro unit will be installed on a particular apparatus. Most of the information contained in the following sections, however, will apply to any situation.

NOTE: *It is strongly recommended that the system be purged of air prior to off-board pick-up operations.*

The foam system must be mounted where the system operator has access to the calibrate inject valve.

Read these sections thoroughly. Plan and design where and how to install this equipment in the apparatus before beginning the actual installation. The following diagrams provide guidelines for the location of the system components.

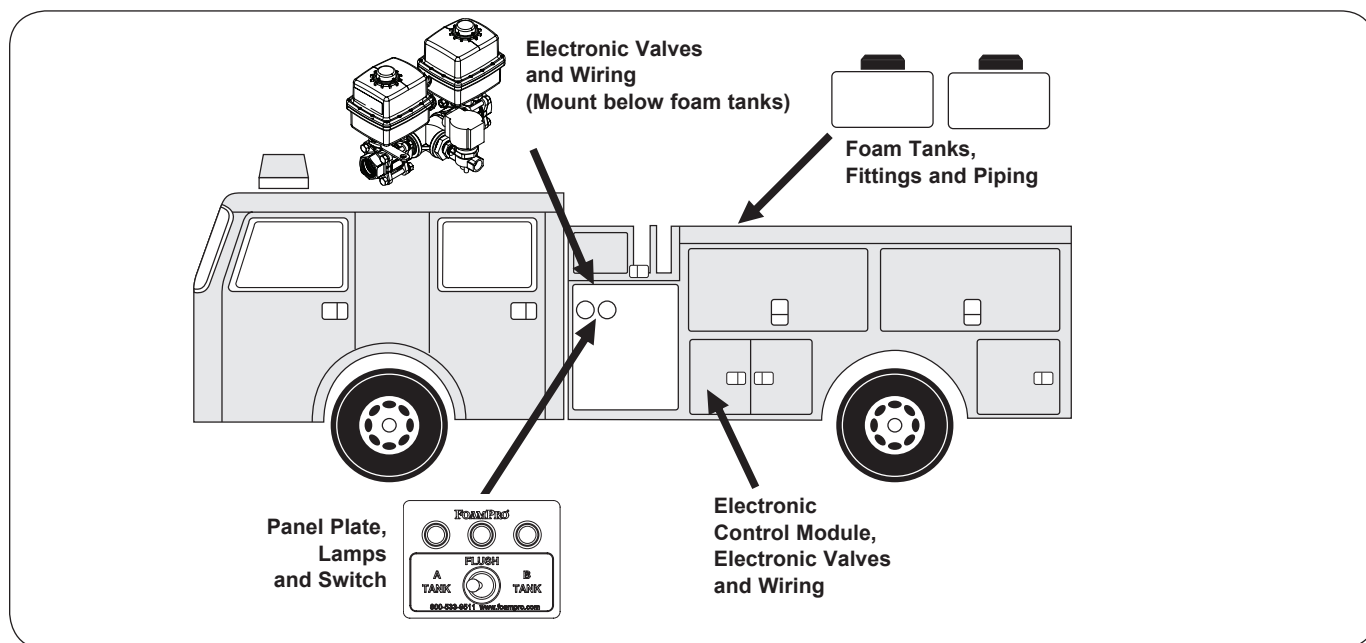

6 Plumbing the System

The system diagram on the following page shows the foam tank to foam pump inlet piping. Always use hose, fittings and pipe that are compatible with foam agents. Make all connections vacuum tight to ensure proper operation.

Mount the selector valve in a position to allow gravity feed from the foam tank through the valve and to the foam pump.

The flush solenoid requires mounting so that the coils are vertical above the valve portion of the valve (located on a horizontal plane). If the flush solenoid is removed from the main valve assembly, ensure that the valve port and coil orientation remain the same.

It should be noted that per the system manual provided, the CAL/INJECT valve "shall be accessible by the pump operator during normal operations". See system Operators Section 6 for more information.

Concentrate Management Plumbing Diagram

Single Tank System

NOTE:

To assist in priming the system, the calibrate inject valve may be mounted remotely. When mounting remotely, use a minimum of 1/2" ID. line rated for 400 PSI. Connect the valve line from the foam pump to the calibrate inject valve and from the calibrate inject valve to the injection point.

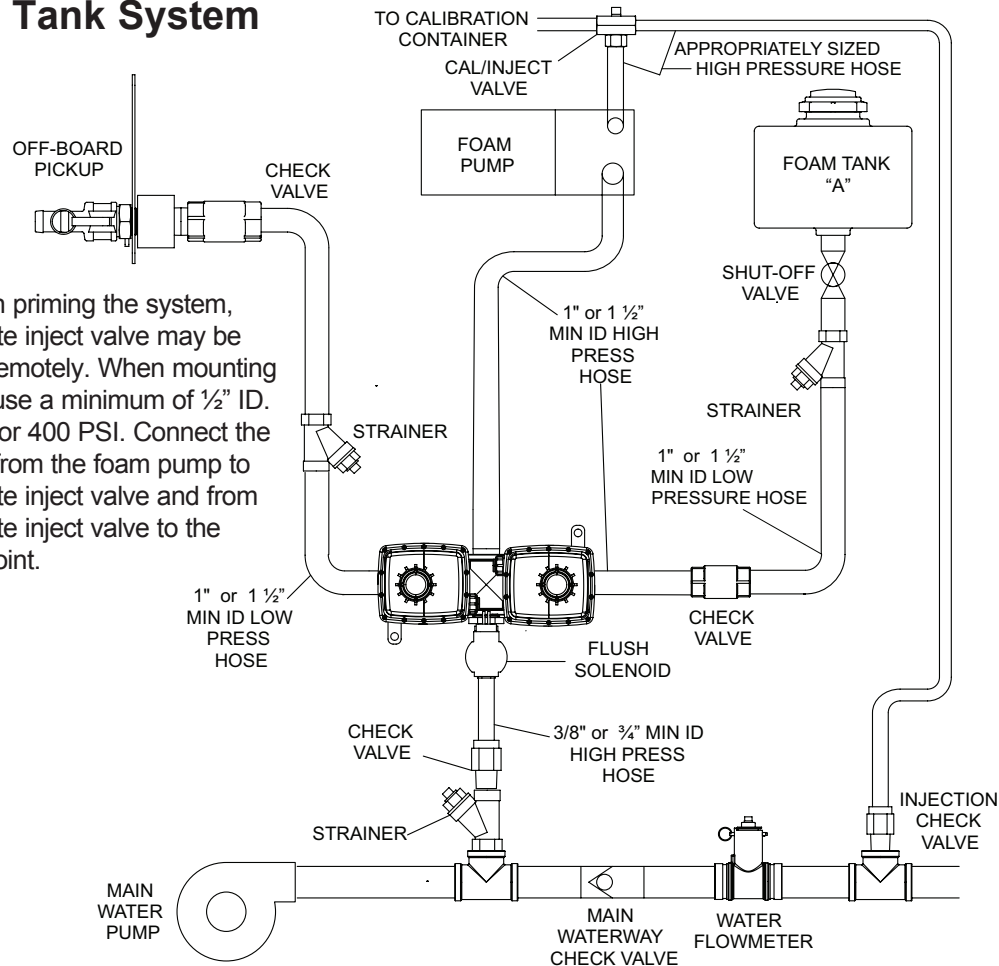

NOTES:

1. Make sure the strainers are mounted in an accessible location because they require regular maintenance.
2. Low pressure hoses and fittings from the foam sources to the selector valve should be good for 23 inches (584 mm) Hg vacuum and 50 psi (3 BAR) working pressure. All other hoses should be rated for full discharge pressure of the main water pump [400 psi (28 BAR) minimum working pressure].
3. Hoses from each source should be connected to the valve appropriate ball port. The flush line should always be connected to the attached solenoid valve.
4. All hoses in the above diagram are high pressure [400 psi (28 BAR) minimum working pressure] unless otherwise noted.
5. It is recommended that the low pressure hose used on the foam suction be of clear construction so foam flow may be observed. See the diagram above.
6. The 1" CMS requires 1" minimum ID hose and the 1-1/2" CMS requires 1-1/2" minimum ID hose.

Concentrate Management Plumbing Diagram

Dual Tank System

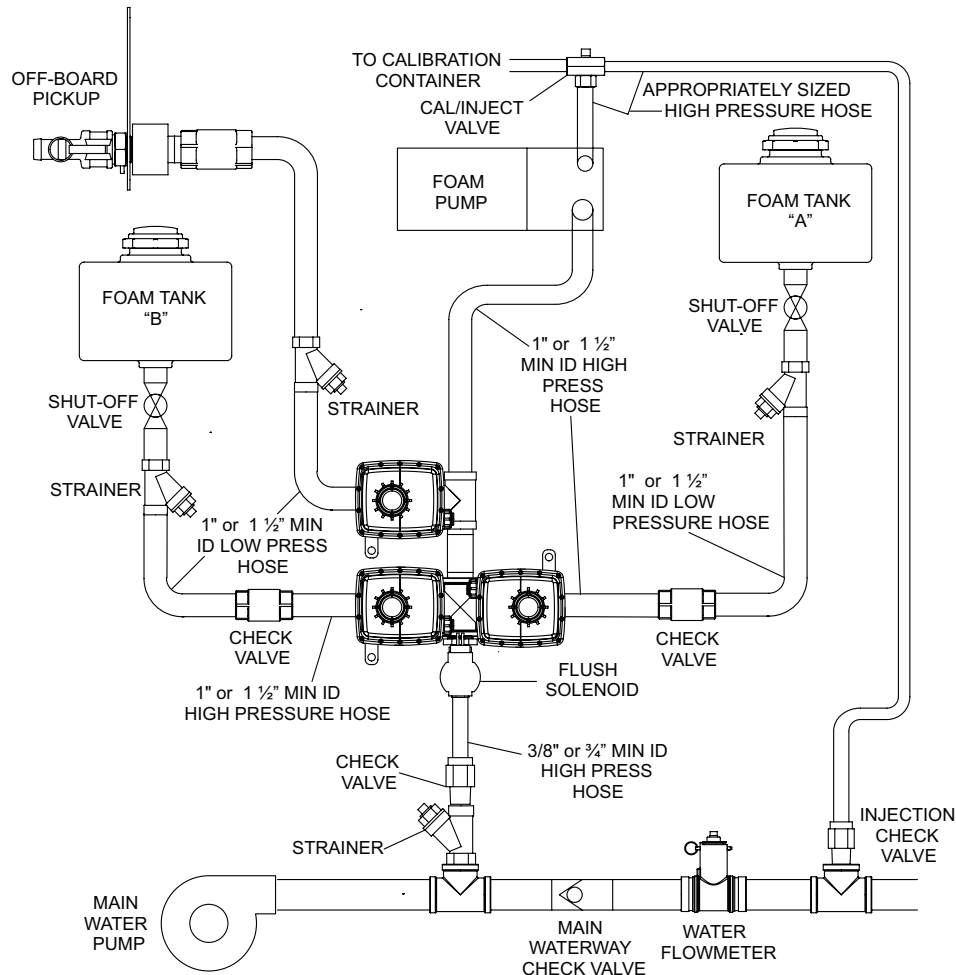

NOTE:

To assist in priming the system, the calibrate inject valve may be mounted remotely. When mounting remotely, use a minimum of 1/2" ID. line rated for 400 PSI. Connect the valve line from the foam pump to the calibrate inject valve and from the calibrate inject valve to the injection point.

7 Electronic Component Installation

Electrical devices can be damaged, or operate intermittently when powered by a weak or erratic power supply. The FoamPro CMS system is not any different – the better the power supply, the better the system will perform. Following the instructions that follow will ensure the FoamPro system will perform at its best.

Ensure that the electrical source of power for the CMS system is the appropriate 12 or 24 volt, negative ground, DC system. Power and ground lines must come directly from the battery without other connections to other high power devices, such as primer pumps, hose reels, light bars, etc. It is recommended to connect the power and ground connections to the power and ground supply to the FoamPro foam injection system. Power required for the CMS system must have a minimum current rating of 5 amps. Provide a 5 or 7.5 amp fuse on the main power source to the system. Please see the diagram as follows ([on the top of page 9](#)) for proper hookup.

Schematics for the single tank with off-board pickup and dual tanks with off-board pickup can be found on pages 16-17.

Locate and mount the control module in an area on the apparatus that is readily accessible. Mounting dimensions are provided in Section 11 on page 15. Although the module is designed to be water resistant, it must be mounted away from water and road spray to avoid excessive terminal corrosion and short circuits.

Use standard 16 AWG or larger automotive wire that is grease and fuel resistant. When connecting wires to the terminals, remove only 1/4 inch of the insulation from the end of the wire. Support all wiring to prevent short circuits and broken wires at the terminal block.

Radios, generators, and other electrical equipment and power lines can cause power line interference. The usage of filters, capacitors, or shielding as necessary can ensure a “clean” appropriate power source is available for the CMS system.

CAUTION: Low battery voltage or voltage drop can cause the CMS system to shift tanks or flush momentarily.

NOTE: Installed in this manner the CMS will only cycle though the FLUSH mode when the relay or solid state contactor is engaged. If not installed in this manner the CMS will cycle through the FLUSH mode every time the apparatus is powered up. This may cause a loss of foam or flush water to accumulate in the apparatus plumbing.

NOTE: If valves are to be manually operated during a system failure, power must be removed from the valves to avoid damage to the valve actuators. This can be done by disconnecting the Weatherpack connectors from the valves or by installing a switch for power to the valves.

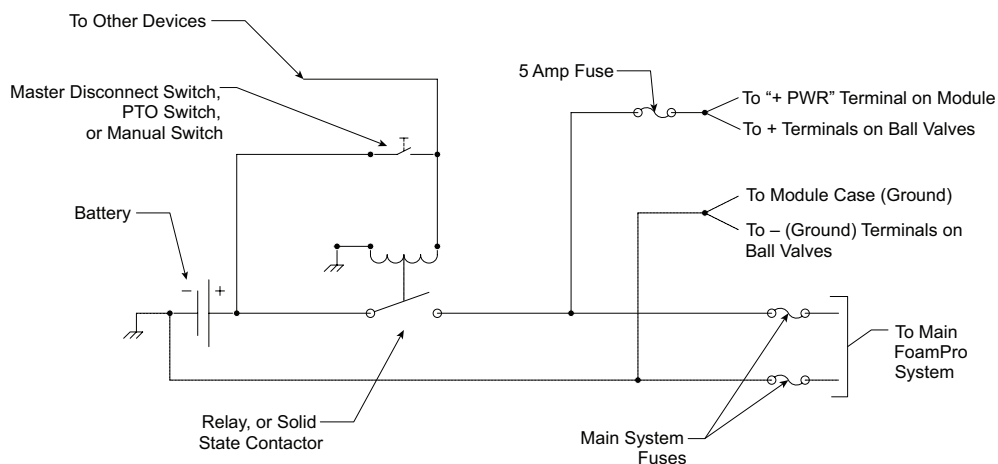

FOAM TANK LEVEL SENSOR

A foam tank level sensor must be mounted into the bottom of each foam tank to monitor low concentrate condition. The sensor has 1/8-inch NPT threads. Mount the sensor in the bottom of the foam tank in an upright position. Use suitable sealant to prevent concentrate leakage. There must be room under the tank to route the cable back to the pump/motor base unit.

When the bottom of the tank is not accessible, the low-level sensor float switches can be hung from a long nipple attached to the top of the tank. Make sure the nipple is strong enough to withstand the force of sloshing foam when the vehicle is in motion. Since wire connections must be made inside the nipple, a 3/8-inch NPT nipple with a 3/8 x 1/8-inch NPT reducer at the lower end is the minimum recommended size.

Check the low-level sensor with a powered test light. With no foam in the tank, the switch contacts should be closed and the test light should be on. If this is not the case, remove the clip from the end of the low-tank sensor. Remove the float and reinstall 180° out of position. Reinstall clip. Retest the switch to ensure it is working properly.

A side-mount, tank level sensor is available to be used if both the top and bottom of the foam tank is not accessible. The side-mount, tank level sensor has 1/2-inch NPT threads and must be installed as close to the bottom of the foam tank as possible. After installation, the sensor must be sealed with a suitable sealant to prevent concentrate leakage.

Check the side-mount, tank level sensor with a powered test light. With no foam in the tank, the light should be on. If the light does not come on, reposition the switch until the test light is on.

Reseal the switch to prevent concentrate leakage after the switch is in the proper position.

NOTE: Install low-level sensor not to interfere with tank discharge.

NOTE: Failure to install low-tank switches will void the FoamPro warranty.

NOTE: Off-board pickup must be monitored annually. If allowed to run without foam, the foam pump may be damaged.

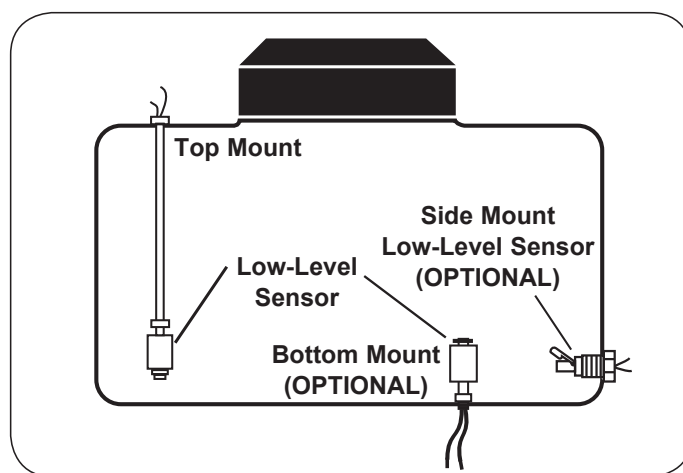

Concentrate Management System Electrical Hookup Dual Tank On-Board with Off-Board Pick Up

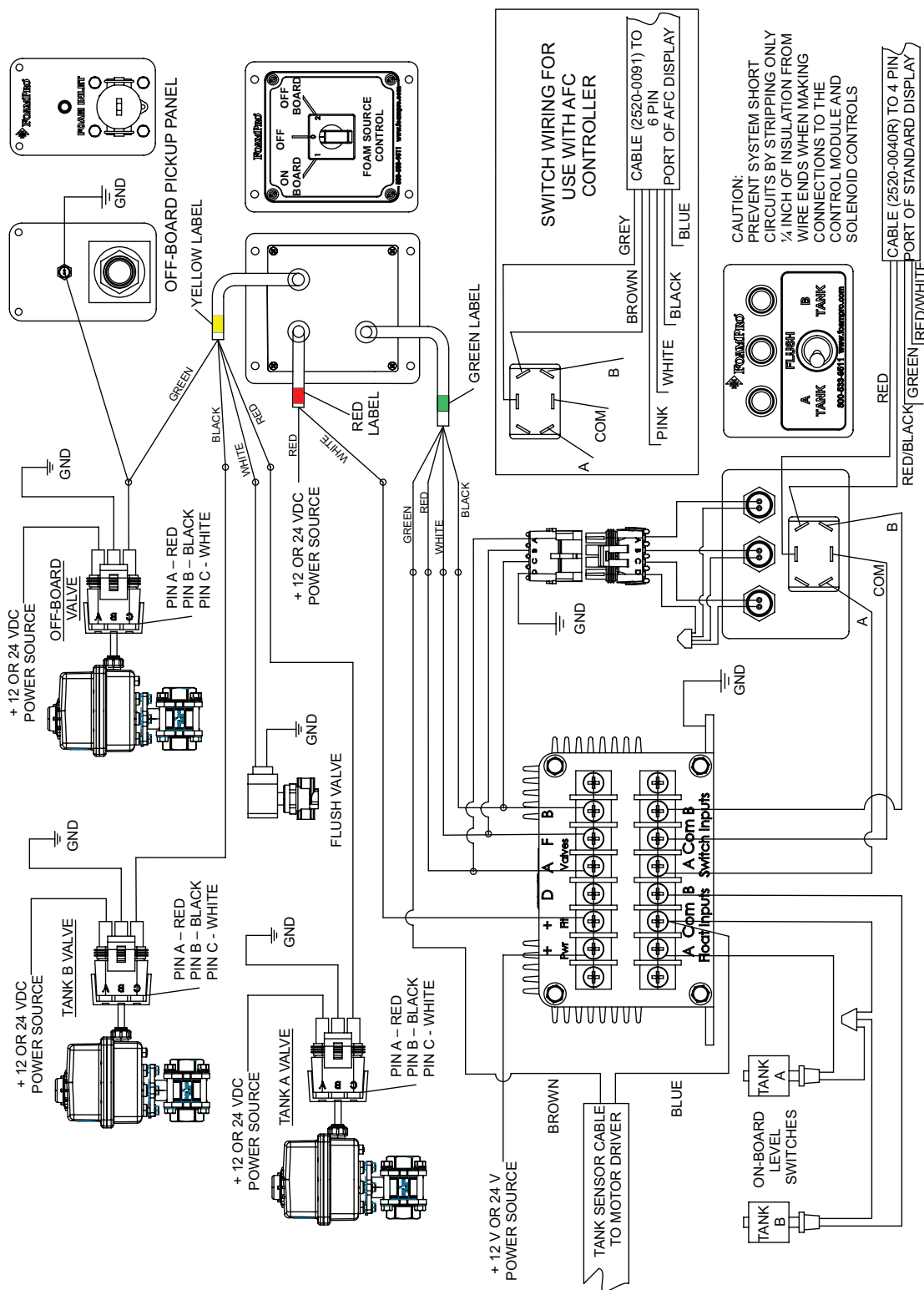

8 Operating Instructions

Single On-Board Tank with Off-Board Pickup

To use the On-Board foam tank:

- Ensure the On-Board/Off-Board Switch is in the On-Board position.
- The system will automatically flush for approximately 8 seconds when changing tanks
- After the flush cycle is completed the selected tank valve will open

To use the Off-Board Pickup:

- Ensure the Off-Board pickup hose is connected and the dip tube is placed in a container of foam or water
- Move the On-Board/Off-Board switch to the Off-Board position
- The system will automatically flush for approximately 8 seconds
- Start the foam system while in flush mode to complete the priming process
- Continue operations
- When operations are completed flush the system as described below

To flush the Off-Board portion of the system:

- Ensure the On-Board/Off-Board switch is in the Off-Board position
- Place the pickup tube in a bucket of fresh water and run the foam pump until you have run approximately 5 gallons of fluid.
- Turn the On-Board/Off-Board switch to the On-Board position

NOTE: A flush cycle will occur for 8 seconds when switching foam sources or when the system is powered up in a particular mode. This cycle will consist of an 8 second flush. Flushing is activated for approximately 1 minute when the toggle switch is in the 'FLUSH' (center) position. The foam pump should be run during the 'FLUSH' cycle to be effective.

Dual On-Board Tanks with Off-Board Pickup

To use the On-Board foam tanks:

- Ensure the On-Board/Off-Board Switch is in the On-Board position.
- Select tank A or B with the A/B selector switch.
- The system will automatically flush for approximately 8 seconds when changing tanks
- Selecting the flush cycle will flush the system for approximately 1 minute and all valves will be closed.
- After the flush cycle is completed, the selected tank valve will open

NOTE: The foam pump should be run during the "FLUSH" cycle to be effective.

To use the Off-Board Pickup:

- Ensure the Off-Board pickup hose is connected and the dip tube is placed in a container of foam or water
- Move the A/B selector switch to the desired position
- Turn the On-Board/Off-Board switch to the Off-Board position
- Start the foam system to complete the priming process
- Continue operations
- When operations are completed flush the system as described below

Priming the Foam Pump When Foam Tank Has Run Dry or While Using the Off-Board Pick-Up

In some instances, the foam tank may run dry while operating the FoamPro system. The foam pumps are designed to pump liquid. When the fire pump is running, the foam pumps cannot pump air efficiently against 100 to 150 PSI (7 to 10 BAR) back pressure. To reestablish foam concentrate flow quickly, the following procedure can be used:

1. Turn the CAL/INJECT valve on the foam pump that was running when the foam tank ran dry to the CAL/INJECT position.

2. With the fire pump flowing water from the foam discharge and the FoamPro system energized, make sure the proper foam pump is running.
3. Observe the hose from the CAL/INJECT valve.
4. When foam concentrate flows from the hose, turn the CAL/INJECT valve back to the INJECT position. The pump is now primed and ready for normal operation.
5. If the fire pump is not running, place the FoamPro system into the simulated flow mode and proceed with above steps.

Flushing the System:

- When using the flush cycle, ensure the On-Board/Off-Board switch is in the On-Board position.
 - All valves will close
 - The flush cycle will run for approximately 1 minute
 - Operate the foam pump in this mode for complete flushing
- When flushing the Off-Board portion of the system:
 - Ensure the On-Board/Off-Board switch is in the Off-Board position
 - Place the pickup tube in a bucket of fresh water and run the foam pump until you have run approximately 5 gallons of fluid.
 - Turn the On-Board/Off-Board switch to the On-Board position
 - Turn the A/B selector to the Flush position and run the foam pump to complete the flushing process

Place the A/B selector into the desired default position.

NOTE: It is recommended that the system be returned to the On-Board tank position and in the "A" foam position on the selector for storage.

Vacuum tests should be performed with the selector in the off position to avoid foam concentrate from being drawn into the water pump. Check strainers regularly for excessive contaminants.

NOTE: Close shut-off valves to prevent tank drainage when servicing strainers. Make sure valves are open and the foam pump primed prior to operating foam system. Priming is made easier by switching the CAL/INJECT valve on the FoamPro to the Calibrate position while the foam pump is operating, allowing air to escape from the foam pump and piping. When foam appears at the CAL/INJECT valve, switch the valve back to the inject position to begin proportioning.

NOTE: When the controller default is *not* set to "DUAL. T," the foam source switch will start and stop when switching to the "B" or off-board foam source. See your system installation and operation manual for changing the defaults.

9 Troubleshooting

Most Electronic Concentrate Management System problems can be traced to faulty wiring. Follow the diagrams carefully and check all connections. Make sure constant 12 V DC or 24 V DC power is supplied and solid, clean ground connections are made. Excessive electrical interference or momentary low voltage on the power line can cause erratic operation. A capacitor or filter on the power line will help to prevent power interference from affecting the control module. Make sure a “clean” appropriate power supply is available and dedicated to the control module of the Concentrate Management System.

Valves may be checked by applying power directly to each white, Pin C wire of the control wires. Valves should actuate immediately upon application of power and reset when power is removed.

Often strainers on a new installation will clog immediately due to excessive debris in the foam source and hoses from assembly. If strainers

are clear and foam flow rate is low, debris may have become lodged in valves during assembly. Remove hose assemblies and carefully check valves for debris or obstructions that could block flow. Make sure all strainers are kept clear.

A vertical-mounted (from top or bottom of the tank) foam tank low-level sensor that has the float installed upside down will show a low concentrate reading (LO CON) on the FoamPro display even with a full tank. In this situation, remove the clip, turn the float 180° and reinstall the clip. Recheck the sensor.

Low voltage can cause the system to switch to flush intermittently. The system requires the appropriate constant voltage (12 V DC or 24 V DC) to operate properly. Make sure other accessories are not on the same line causing voltage drop power problems.

10 Parts Identification

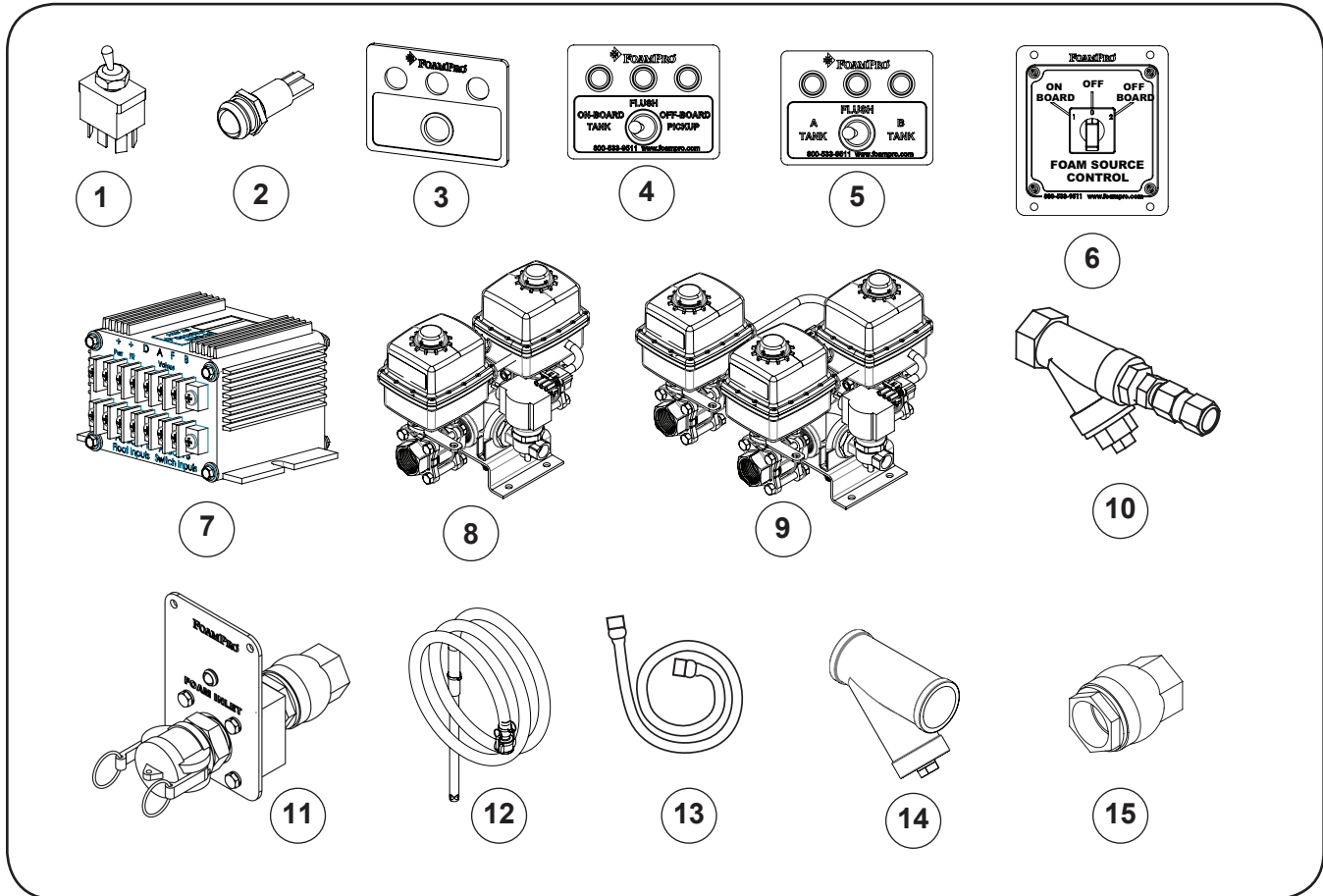

Ref.	Part No.	Description
1	2530-0050	Switch, Toggle
2	2530-0153	Lamp, LED
3	6032-0064	Placard, Blank
4	3435-0183	Off-Board Panel Switch Assembly
5	3435-1001	Dual Tank Panel Switch Assembly
6	3435-1004	Dual Tank & Off-Board Selector Switch Assembly
7	2527-0077	CMS Control Module
8	3435-0136	1" Dual-Tank Selector Valve Assy. - 12VDC
8	3435-0137	1" Dual-Tank Selector Valve Assy. - 24VDC
8	3435-0167	1-1/2" Dual-Tank Selector Valve Assy. - 12VDC
8	3435-0168	1-1/2" Dual-Tank Selector Valve Assy. - 24VDC
9	3435-1002	1" Dual-Tank & Off-Board Selector Valve Assy. - 12VDC
9	3435-1011	1" Dual-Tank & Off-Board Selector Valve Assy. - 24VDC
9	3435-1013	1 1/2" Dual-Tank & Off-Board Selector Valve Assy. - 12VDC
9	3435-1014	1 1/2" Dual-Tank & Off-Board Selector Valve Assy. - 24VDC

Ref.	Part No.	Description
10	3430-0624	1" Flush Check Valve and Strainer Assy
10	3430-0776	1 1/2" Flush Check Valve and Strainer Assy
11	3435-0181	1" Off-Board Inlet Panel Assy
11	3435-1015	1 1/2" Off-Board Inlet Panel Assy
12	3435-0182	1" Off-Board Suction Hose Kit
12	3435-1016	1 1/2" Off-Board Suction Hose Kit
13	2520-0040R	Control Cable Interface STD
13	2520-0091	Control Cable Interface AFC
14	3350-0144SS	1" Line Strainer
14	3350-0146	2" Line Strainer
15	3320-0044	1" Tank Line Check Valve
15	3320-0048	1 1/2" Tank Line Check Valve

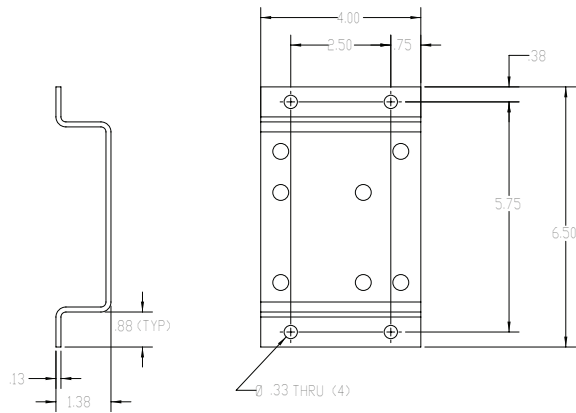

**1510-0115 MOUNTING PLATE PATTERN
FOR VALVE ASSEMBLIES**

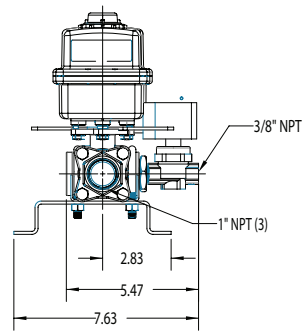

3435-0136 & 3435-0137 1" DUAL TANK VALVE ASSEMBLY

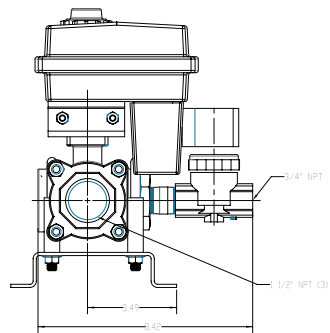
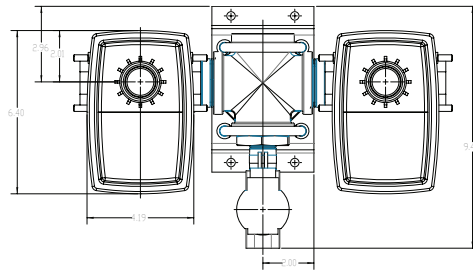
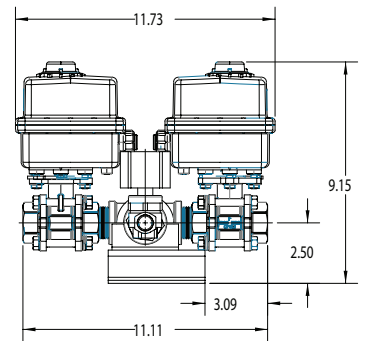
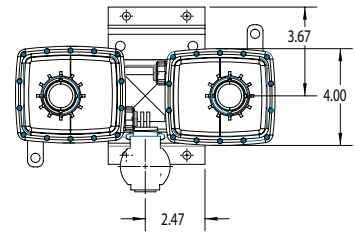

3435-0167 & 3435-0168 1 1/2" DUAL TANK VALVE ASSEMBLY

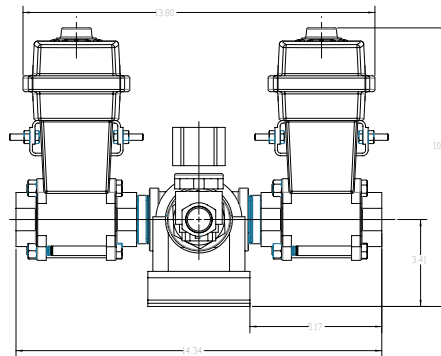

Electronic Concentrate Management System

Installation and Operation Manual

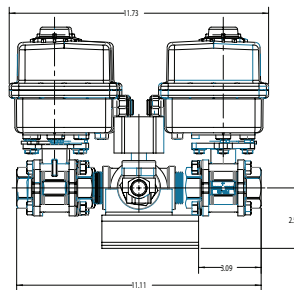
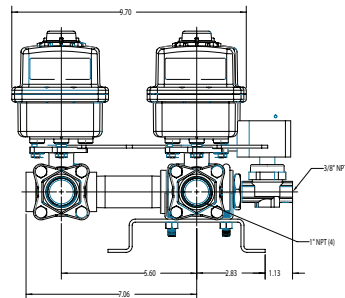
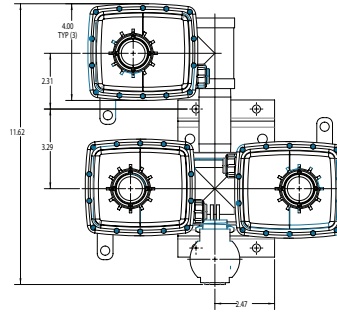

3435-1002 & 3435-1011 1" DUAL TANK AND OFF-BOARD PICKUP VALVE ASSEMBLY

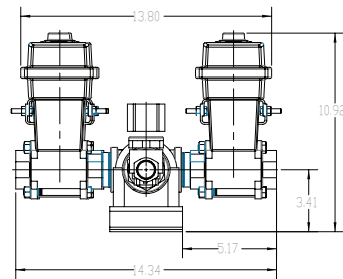
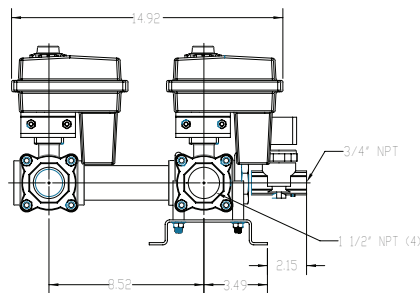
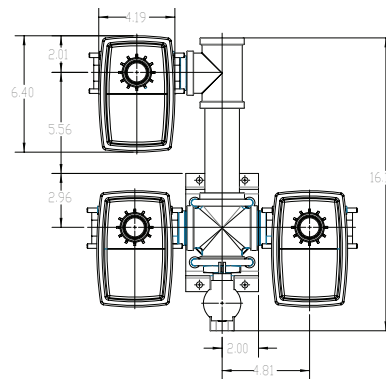

3435-1013 & 3435-1014 1 1/2" DUAL TANK AND OFF-BOARD PICKUP VALVE ASSEMBLY

12 Limited Warranty

Fire Research Corp. (FRC), as supplier of FoamPro, warrants to the original purchaser, each new pump, system or other product of its own manufacture, for a period of two years from the date of shipment from the factory, to be free from defects in material and workmanship under normal use and service. "Normal use and service" means not in excess of recommended maximum speeds, pressures, and temperatures, or handling fluids not compatible with components materials, as noted in applicable FoamPro product catalogs, technical literature, and instructions. This warranty shall not apply to any pump, system or other product which shall have been repaired or altered to adversely affect the performance or reliability of the pump, system or other product.

Neither this warranty nor any implied warranty apply to damage or harm caused by any or all of the following: (1) Freight damage; (2) Freezing damage; (3) Damage caused by parts and/or accessories or components not obtained from or approved by FRC; (4) ANY CONSEQUENTIAL OR INCIDENTAL DAMAGES, OTHER THAN INJURY TO THE PERSON, ARISING FROM THE USE OF ANY PUMP OR OTHER PRODUCT MANUFACTURED BY FRC EXCEPT in states that do not allow the exclusion or limitation of incidental or consequential damages; (5) Damage due to misapplication and/or misuse; (6) Normal wear of moving parts or components affected by moving parts.

The liability of FRC under the foregoing warranty is limited to the repair or replacement at FRC's option without charge for labor or materials of any parts upon return of the entire pump, system or other product or of the particular part to the FRC factory within the warranty period, at the sole expense of the purchaser, which part shall upon examination appear to FRC's satisfaction to have been defective in material and workmanship. The liability of FRC under any theory of recovery (except any express warranty where the remedy is set forth in the above paragraph) for loss, harm or damage, shall be limited to the lesser of the actual loss, harm or damage or the purchase price of the involved pump, system or other product when sold by FRC to its customer.

FRC expressly warrants its pumps and other products as above stated. THERE ARE NO OTHER EXPRESS WARRANTIES. ANY IMPLIED WARRANTIES, INCLUDING IMPLIED WARRANTY OF MERCHANTABILITY OR OF FITNESS FOR A PARTICULAR PURPOSE, ARE LIMITED IN DURATION TO TWO YEARS FROM THE DATE OF PURCHASE BY THE ORIGINAL PURCHASER EXCEPT in states that do not allow time limitations on implied warranties. THERE IS NO IMPLIED WARRANTY OF FITNESS FOR A PARTICULAR PURPOSE OR MERCHANTABILITY WHEN THIS PRODUCT IS PUT TO RENTAL USE.

No person including any dealer or representative of FoamPro is authorized to make any representation or warranty concerning FRC's FoamPro products on behalf of FRC, or to assume for FRC the obligations contained in this warranty. FRC reserves the right to make changes in design and other changes and improvements upon its products without imposing any obligations upon itself to install the same, upon its existing products then in process or manufacture.

This warranty gives you specific legal rights, and you may also have other rights which vary from state to state.

IMPORTANT NOTICE

It is imperative to package all FoamPro components properly, before shipment (with Return Goods Authorization attached) back to FRC. The FoamPro contains electronic components that may receive damage from improper shipping procedures! All FoamPro components shipped back to FRC will pass through Quality Control Inspection, and will be photographed after the box is opened. Any shipping damage, such as superficial scratches, nicks, etc., to the unit makes it unusable (even after the internal warranty problem is repaired) and thus must be refinished to "like-new" condition during the warranty process. You are responsible for any physical damage occurring to FoamPro components at your facility and during shipment back to FRC.

Package the FoamPro, complete with all the recommended parts the Customer Service representative requires (i.e., Digital Display control with all premolded wire cables etc.) in its original carton with the Styrofoam and other packaging materials, as it was received at your facility. FRC appreciates your attention in this matter, as we feel it will help us to serve you in a better fashion, while keeping the cost of the FoamPro product competitive. Thank you.